

TYPICAL BRANCH CONNECTION
AT INTERSECTION
NTS

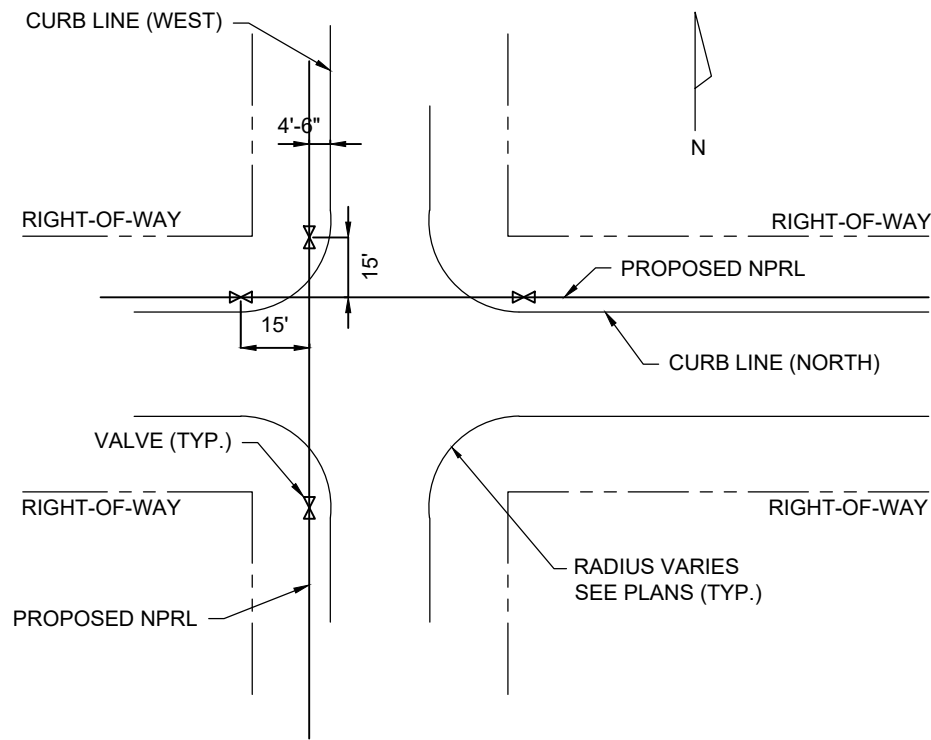

SUBDIVISION INTERSECTION
DETAIL VALVE & MAIN
NTS

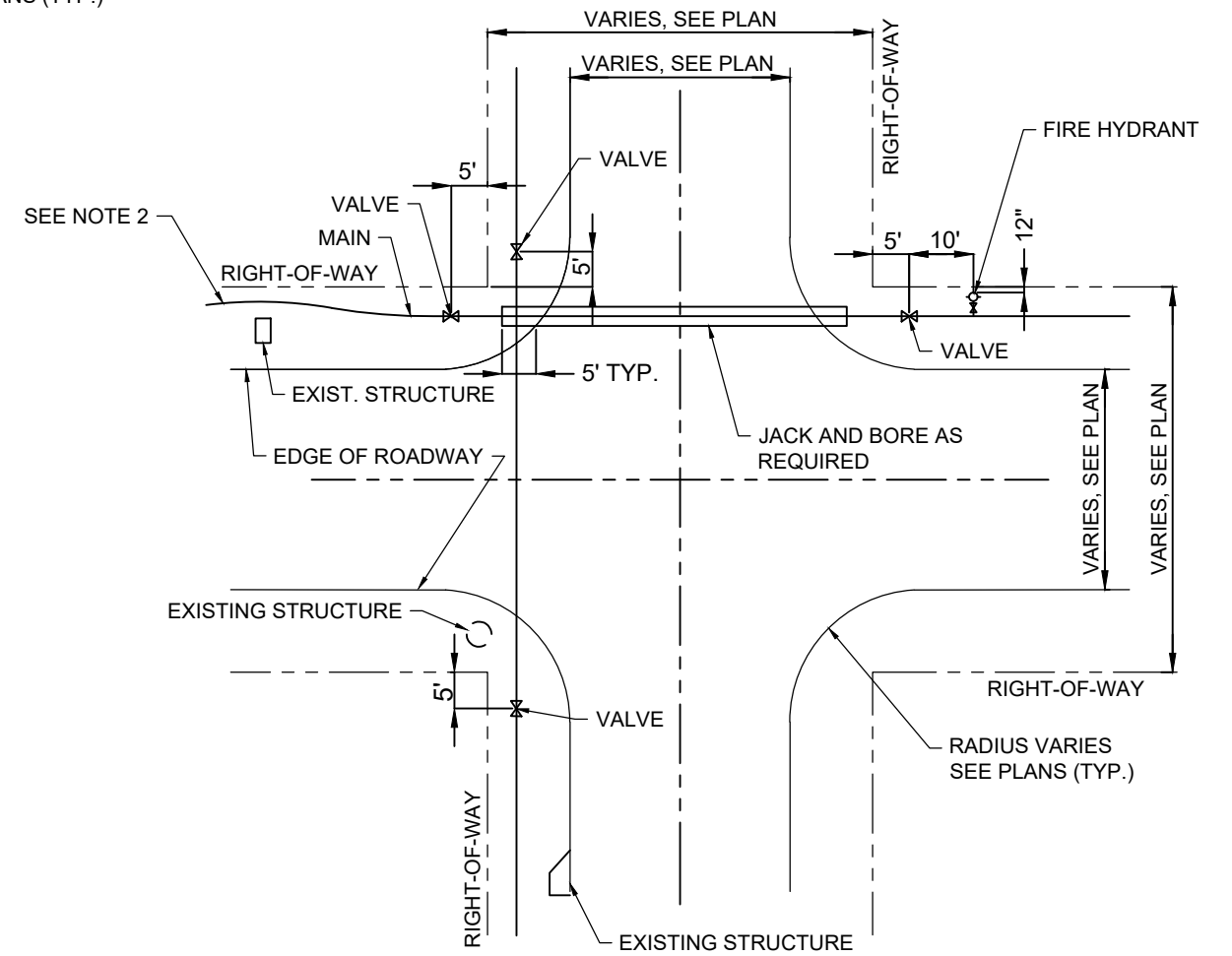

TYPICAL WATER MAIN
AT INTERSECTION
NTS

NOTES:

1. DEPTH OF COVER OVER WATER MAINS SHALL BE MINIMUM OF 4 FT.
2. WHEN GOING AROUND STRUCTURES, ROUTE WATER MAIN AROUND STRUCTURES BY PIPE JOINT DEFLECTION, AND WHERE NECESSARY, INSTALL 45° BENDS OR LESS.
3. VALVES SHALL BE MARKED IN THE CURB WITH A SAWCUT "V" AND PAINT.

95% SUBMITTAL

FULTON COUNTY STANDARD DETAIL 133

MAIN EXTENSION BLOCKING DETAILS
AND SUBDIVISION INTERSECTION DETAILS

DATE	REVISIONS	DATE	REVISIONS
M/Y	XXX	M/Y	XXX

DGS/DRN/CHKD: XXX

APPROVED: XXX

DATE: XX-X-XX



FULTON COUNTY PUBLIC WORKS
141 PRYOR ST. ATLANTA, GA. 30303
404-612-7400 FAX: 404-224-0498

DRAWING NO.

133